

# TRAFFIC CRASH REPORT



LOCAL REPORT #  
 1 0 - 0 3 0

CRASH SEVERITY  
 3 1 FATAL 3 PDO  
 2 INJURY 4 UNKNOWN

PRIVATE PROPERTY

HIT/SKIP  
 1 NOT HIT/SKIP  
 2 SOLVED  
 3 UNSOLVED  
 1

PHOTOS TAKEN

OH-2 OH-3 OH-1P OTHER

REPORTING AGENCY #  
 0 5 7 2 4

REPORTING AGENCY  
 BUTLER TOWNSHIP POLICE DEPT.

# UNITS  
 0 1

UNIT #  
 9 8 98 = ANIMAL  
 99 = UNKNOWN

DATE OF CRASH  
 0 2 1 8 2 0 1 0

FILE # OF CRASH  
 0 7 2 6

DAY OF WEEK  
 T H U

CITY VILLAGE TWP

NAME (OF CITY, VILLAGE OR TOWNSHIP)  
 BUTLER (TOWNSHIP OF)

COUNTY #  
 5 7

LATITUDE LONGITUDE

CRASH OCCURRENCE  
 PREFIX CRASH LOCATION  
 FREDERICK PIKE

TYPE LOC  
 1

TYPE LOCATION POINT USED  
 1 NAMED STREET 3 NUMBERED ROUTE  
 2 NUMBERED STREET

LOCAL INCIDENT #  
 10-049-061

AT-RISK URL  
 DIST REFERENCE DR PREFIX REFERENCE REF POINT  
 75' S 10016 0 4

REFERENCE POINT USED  
 01 STATE LINE 04 HOUSE NUMBER  
 02 INTERSECTION 2 STREETS 05 TOWNSHIP BOUNDARY  
 03 COUNTY LINE 06 MILE POST 07 CORPORATE LIMITS  
 08 STATE OR FEDERAL HIGHWAY  
 09 DRIVEWAY

DRIVER # OF VEHICLE NAME (LAST, FIRST, MIDDLE) MATTHEW DONATHAN C

ADDRESS (STREET, CITY, STATE, ZIP CODE) 2484 SOUTH STATE ROUTE 721 LAURA OH 45337

DATE OF BIRTH 1 2 0 4 1 9 8 8 AGE 2 1 SEX M HOME PHONE # 937-520-3462

DL STATE OH DL# LP STATE OH LP# ERW7065 INJURED TAKEN BY 1 NONE 4 OTHER 2 EMS 5 UNKNOWN 3 POLICE TRANSPORTED BY

OWNER NAME (IF SAME, WRITE "SAME") SAME ADDRESS (STREET, CITY, STATE, ZIP CODE) 2484 SOUTH STATE ROUTE 721 LAURA OH 45337

YEAR 2 0 0 5 MAKE DODGE MODEL RAM / 1500 COLOR BLACK INSURANCE COMPANY MOTORIST MUTUAL TOWING SERVICE OWNER PHONE # 937-520-3462

OFFENSE CHARGED OFFENSE DESCRIPTION CREATION # LOCAL CODE # IF YES

UNIT # NAME (LAST, FIRST, MIDDLE) ADDRESS (STREET, CITY, STATE, ZIP CODE)

DATE OF BIRTH AGE SEX HOME PHONE # WORK PHONE #

DL STATE OH DL# LP STATE OH LP# ERW7065 INJURED TAKEN BY 1 NONE 4 OTHER 2 EMS 5 UNKNOWN 3 POLICE TRANSPORTED BY INJURED TAKEN TO

OWNER NAME (IF SAME, WRITE "SAME") ADDRESS (STREET, CITY, STATE, ZIP CODE)

YEAR MAKE MODEL COLOR INSURANCE COMPANY TOWING SERVICE OWNER PHONE #

OFFENSE CHARGED OFFENSE DESCRIPTION CREATION # LOCAL CODE # IF YES

UNIT # NAME (LAST, FIRST, MIDDLE) HOME PHONE # DATE OF BIRTH AGE SEX

INJURED TAKEN BY 1 NONE 4 OTHER 2 EMS 5 UNKNOWN 3 POLICE TRANSPORTED BY INJURED TAKEN TO

OWNER NAME (IF SAME, WRITE "SAME") HOME PHONE # DATE OF BIRTH AGE SEX

INJURED TAKEN BY 1 NONE 4 OTHER 2 EMS 5 UNKNOWN 3 POLICE TRANSPORTED BY INJURED TAKEN TO

ADDRESS (STREET, CITY, STATE, ZIP CODE)

MOTORIST/NON-MOTORIST

Occupant

SEATING POSITION 0 1 01 FRONT-LEFT (MC DRIVER) 02 FRONT-MIDDLE 03 FRONT-RIGHT 04 SECOND-LEFT (MC PASS) 05 SECOND-MIDDLE 06 SECOND-RIGHT 07 THIRD-LEFT (MC PASSENGER/SIDE CAR) 08 THIRD-MIDDLE 09 THIRD-RIGHT 10 SLEEPER SECTION OF CAB 11 ENCLOSED CARGO AREA 12 UNENCLOSED CARGO AREA 13 TRAILING UNIT 14 EXTERIOR 15 OTHER 16 NON-MOTORIST 17 UNKNOWN	SAFETY EQUIPMENT 0 4 01 NONE USED 02 SHOULDER BELT ONLY 03 LAP BELT ONLY 04 SHOULDER/LAP BELT 05 CHILD SAFETY SEAT 06 MC HELMET USED 07 USE UNKNOWN NON-MOTORIST 08 NONE USED 09 HELMET USED 10 PROTECTIVE PADS 11 REFLECTIVE CLOTHING 12 LIGHTING 13 OTHER 14 UNKNOWN	AIR BAG 1 A 1 NOT-DEPLOYED 2 DEPLOYED-FRONT 3 DEPLOYED-SIDE 4 DEPLOYED BOTH FRONT/SIDE 5 NOT APPLICABLE 8 UNKNOWN	AIR BAG SWITCH 1 A 1 NOT PRESENT 2 IN ON POSITION 3 IN OFF POSITION 4 UNKNOWN	EJECTION 1 A 1 NOT EJECTED 2 TOTALLY EJECTED 3 PARTIALLY EJECTED 4 NOT APPLICABLE 5 UNKNOWN	TRAPPED 1 A 1 NOT TRAPPED 2 EXTRICATED BY MECHANICAL MEANS 3 FREED BY NON-MECHANICAL MEANS 4 UNKNOWN	INJURIES 1 A 1 NO INJURY 2 POSSIBLE 3 NON-INCAPACITATING 4 INCAPACITATING 5 FATAL INJURY 6 UNKNOWN
--	--	--	--	---	---	---



UNIT NUMBERS  
0 1

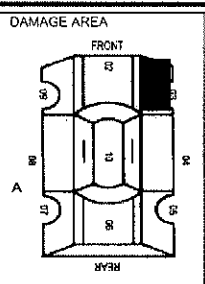

NON-MOTORIST LOCATION

- 01 MARKED CROSSWALK AT INTERSECTION
- 02 INTERSECTION/NO CROSSWALK
- 03 NON-INTERSECTION CROSSWALK
- 04 DRIVEWAY ACCESS CROSSWALK
- 05 IN ROADWAY
- 06 NOT IN ROADWAY
- 07 MEDIAN (BUT NOT SHOULDER)
- 08 ISLAND
- 09 SHOULDER
- 10 SIDEWALK
- 11 WITHIN 10 FEET OF ROADWAY (NOT SHOULDER, MEDIAN, SIDEWALK, ISLAND)
- 12 BEYOND 10 FEET OF ROADWAY (WITHIN TRAFFICWAY)
- 13 OUTSIDE TRAFFICWAY
- 14 SHARED USE PATHS OR TRAILS
- 15 UNKNOWN

TYPE OF UNIT  
0 7

- MOTORIST**
- 01 SUB-COMPACT
  - 02 COMPACT
  - 03 MID SIZE
  - 04 FULL SIZE
  - 05 MINIVAN
  - 06 SPORT UTILITY VEHICLE
  - 07 PICKUP
  - 08 PANELVAN
  - 09 SINGLE UNIT TRUCK: 2 AXELS, 6 TIRES
  - 10 SINGLE UNIT TRUCK, 3+ AXLES
  - 11 TRACTOR/TRAILER
  - 12 TRUCK TRACTOR (BOBTAIL)
  - 13 TRACTOR/SEMI-TRAILER
  - 14 TRACTOR/DOUBLE SHORT
  - 15 TRACTOR/DOUBLE LONG
  - 16 FIFTI WHEEL OR CONVERTER ODLY
  - 17 TRACTOR/TRIPLES
  - 18 MOTORCYCLE
  - 19 MOTORIZED BICYCLE
  - 20 SCHOOL BUS
  - 21 CHURCH BUS
  - 22 PUBLIC BUS
  - 23 OTHER BUS
  - 24 POLICE VEHICLE
  - 25 FIRE TRUCK
  - 26 AMBULANCE/RESCUE
  - 27 TAXI
  - 28 MOTOR HOME
  - 29 TRAIN
  - 30 FARM VEHICLE
  - 31 FARM EQUIPMENT
  - 32 SNOWMOBILE
  - 33 CONSTRUCTION EQUIPMENT
  - 34 ALL OTHERS
- NON-MOTORIST**
- 35 ANIMAL W/DRIVER
  - 36 ANIMAL, W/BUGGY
  - 37 BICYCLE
  - 38 PEDESTRIAN
  - 39 PEDALCYCLIST
  - 40 SKATER
  - 41 OTHER NON-MOTORIST
  - 42 UNKNOWN

IN EMERGENCY RESPONSE

DAMAGE SCALE  
3

- 1 NONE
- 2 NON-FUNCTIONAL DAMAGE
- 3 FUNCTIONAL DAMAGE
- 4 DISABLING DAMAGE
- 5 SEVERE
- 6 UNKNOWN

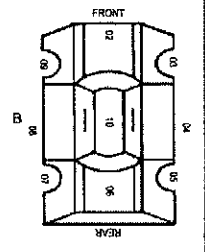

MOST DAMAGED AREA  
0 3

- 01 NONE
- 02 CENTER FRONT
- 03 RIGHT FRONT
- 04 RIGHT SIDE
- 05 RIGHT REAR
- 06 REAR CENTER
- 07 LEFT REAR
- 08 LEFT SIDE
- 09 LEFT FRONT
- 10 TOP AND WINDOWS
- 11 UNDERCARRIAGE
- 12 LOAD/TRAILER
- 13 TOTAL (ALL AREAS)
- 14 OTHER
- 15 UNKNOWN

- POINT OF IMPACT**
- 01 NONE
  - 02 CENTER FRONT
  - 03 RIGHT FRONT
  - 04 RIGHT SIDE
  - 05 RIGHT REAR
  - 06 REAR CENTER
  - 07 LEFT REAR
  - 08 LEFT SIDE
  - 09 LEFT FRONT
  - 10 TOP AND WINDOWS
  - 11 UNDERCARRIAGE
  - 12 LOAD/TRAILER
  - 13 TOTAL (ALL AREAS)
  - 14 OTHER
  - 15 UNKNOWN

- ACTION**
- 1 NON CONTACT
  - 2 NON-COLLISION
  - 3 STRIKING
  - 4 STRUCK
  - 5 BOTH STRIKING AND STRUCK
  - 6 UNKNOWN

- STRIKING VEHICLE: OVERRIDE/ UNDERRIDE**
- 1 NO UNDERRIDE OR OVERRIDE
  - 2 UNDERRIDE, COMPARTMENT INTRUSION
  - 3 UNDERRIDE, NO COMPARTMENT INTRUSION
  - 4 UNDERRIDE, COMPARTMENT INTRUSION UNKNOWN
  - 5 OVERRIDE, MOTOR VEHICLE IN TRANSPORT
  - 6 OVERRIDE, OTHER VEHICLE
  - 7 UNKNOWN

PRE-CRASH ACTIONS  
0 1

- MOTORIST**
- 01 MOVEMENTS ESSENTIALLY STRAIGHT AHEAD
  - 02 BACKING
  - 03 CHANGING LANES
  - 04 OVERTAKING/PASSING
  - 05 TURNING RIGHT
  - 06 TURNING LEFT
  - 07 MAKING U-TURN
  - 08 ENTERING TRAFFIC LANE
  - 09 LEAVING TRAFFIC LANE
  - 10 PARKED
  - 11 SLOWING/STOPPED IN TRAFFIC
  - 12 DRIVERLESS
  - 13 OTHER
  - 14 UNKNOWN
- NON-MOTORIST**
- 15 ENTERING/CROSSING IN SPECIFIED LOCATION
  - 16 WALKING, RUNNING, JOGGING, PLAYING, CYCLING
  - 17 WORKING
  - 18 PUSHING VEHICLE
  - 19 APPROACHING, LEAVING VEHICLE
  - 20 PLAYING/WORKING ON VEHICLE
  - 21 STANDING
  - 22 OTHER
  - 23 UNKNOWN

- CONTRIBUTING CIRCUMSTANCES**
- 01 NONE
  - 02 FAILURE TO YIELD
  - 03 RAN RED LIGHT, OR STOP SIGN
  - 04 EXCEEDED SPEED LIMIT
  - 05 UNSAFE SPEED
  - 06 IMPROPER TURN
  - 07 LEFT OF CENTER
  - 08 FOLLOWED TOO CLOSELY/ACDA
  - 09 IMPROPER LANE CHANGE/ IMPROPER PASSING
  - 10 IMPROPER BACKING
  - 11 IMPROPER START FROM PARKED POSITION
  - 12 STOPPED OR PARKED ILLEGALLY
  - 13 OPERATING VEHICLE IN ERRATIC, RECKLESS, CARELESS, NEGLIGENT OR AGGRESSIVE MANNER
  - 14 SWERVING TO AVOID (DUE TO WIND, SLIPPERY SURFACE, VEHICLE, OBJECT, NON-MOTORIST IN ROADWAY, ETC)
  - 15 FAILURE TO CONTROL
  - 16 VISION OBSTRUCTION
  - 17 DRIVER INATTENTION
  - 18 FATIGUE/ASLEEP
  - 19 OPERATING DEFECTIVE EQUIPMENT
  - 20 LOAD SHIFTING/FALLING/SPILLING
  - 21 OTHER IMPROPER ACTION
  - 22 UNKNOWN
  - 23 NONE
  - 24 IMPROPER CROSSING
  - 25 DARTING
  - 26 LYING AND/OR ILLEGALLY IN ROADWAY
  - 27 FAILURE TO YIELD RIGHT OF WAY
  - 28 NOT VISIBLE (DARK CLOTHING)
  - 29 INATTENTIVE
  - 30 FAILURE TO OBEY TRAFFIC SIGNS, SIGNALS, OR OFFICER
  - 31 WRONG SIDE OF THE ROAD
  - 32 OTHER
  - 33 UNKNOWN

CONTRIBUTING CIRCUMSTANCES  
0 1

- MOTORIST**
- 01 NONE
  - 02 FAILURE TO YIELD
  - 03 RAN RED LIGHT, OR STOP SIGN
  - 04 EXCEEDED SPEED LIMIT
  - 05 UNSAFE SPEED
  - 06 IMPROPER TURN
  - 07 LEFT OF CENTER
  - 08 FOLLOWED TOO CLOSELY/ACDA
  - 09 IMPROPER LANE CHANGE/ IMPROPER PASSING
  - 10 IMPROPER BACKING
  - 11 IMPROPER START FROM PARKED POSITION
  - 12 STOPPED OR PARKED ILLEGALLY
  - 13 OPERATING VEHICLE IN ERRATIC, RECKLESS, CARELESS, NEGLIGENT OR AGGRESSIVE MANNER
  - 14 SWERVING TO AVOID (DUE TO WIND, SLIPPERY SURFACE, VEHICLE, OBJECT, NON-MOTORIST IN ROADWAY, ETC)
  - 15 FAILURE TO CONTROL
  - 16 VISION OBSTRUCTION
  - 17 DRIVER INATTENTION
  - 18 FATIGUE/ASLEEP
  - 19 OPERATING DEFECTIVE EQUIPMENT
  - 20 LOAD SHIFTING/FALLING/SPILLING
  - 21 OTHER IMPROPER ACTION
  - 22 UNKNOWN
  - 23 NONE
  - 24 IMPROPER CROSSING
  - 25 DARTING
  - 26 LYING AND/OR ILLEGALLY IN ROADWAY
  - 27 FAILURE TO YIELD RIGHT OF WAY
  - 28 NOT VISIBLE (DARK CLOTHING)
  - 29 INATTENTIVE
  - 30 FAILURE TO OBEY TRAFFIC SIGNS, SIGNALS, OR OFFICER
  - 31 WRONG SIDE OF THE ROAD
  - 32 OTHER
  - 33 UNKNOWN

- VEHICLE DEFECT CODE ONLY IF '19' SELECTED ABOVE**
- 01 TURN SIGNALS
  - 02 HEAD LAMPS
  - 03 TAIL LAMPS
  - 04 BRAKES
  - 05 STEERING
  - 06 TIRE BLOWOUT
  - 07 WORN OR SLICK TIRES
  - 08 TRAILER EQUIPMENT DEFECTIVE
  - 09 MOTOR TROUBLE
  - 10 DISABLED FROM PRIOR CRASH
  - 11 OTHER DEFECTS

VEHICLE DEFECT CODE ONLY IF '19' SELECTED ABOVE

SEQUENCE OF EVENTS  
1 8

- 01 OVERTURN/ROLLOVER
- 02 FIRE/EXPLOSION
- 03 IMMERSION
- 04 JACKKNIFE
- 05 CARGO/EQUIPMENT LOSS/SHIFT
- 06 EQUIPMENT FAILURE
- 07 SEPARATION OF UNITS
- 08 RAN OFF ROAD RIGHT
- 09 RAN OFF ROAD LEFT
- 10 CROSS MEDIAN/CENTERLINE
- 11 DOWNHILL RUNAWAY
- 12 OTHER NON COLLISION
- 13 UNKNOWN NON-COLLISION
- 14 COLLISION W/PERSON, VEHICLE, OR OBJECT NOT FIXED
- 15 PEDESTRIAN
- 16 PEDALCYCLE
- 17 RAILWAY VEHICLE
- 18 ANIMAL - FARM
- 19 ANIMAL - DEER
- 20 ANIMAL - OTHER
- 21 MOTOR VEHICLE IN TRANSPORT
- 22 WORK ZONE MAINTENANCE EQUIPMENT
- 23 OTHER MOVABLE OBJECT
- 24 UNKNOWN MOVABLE OBJECT
- 25 COLLISION WITH FIXED OBJECT
- 26 IMPACT ATTENUATOR/CRASH CUSHION
- 27 BRIDGE OVERHEAD STRUCTURE
- 28 BRIDGE PIER OR ABUTMENT
- 29 BRIDGE PARAPET
- 30 BRIDGE RAIL
- 31 GUARDRAIL FACE
- 32 GUARDRAIL END
- 33 MEDIAN BARRIER
- 34 HIGHWAY TRAFFIC SIGN POST
- 35 OVERHEAD SIGN POST
- 36 LIGHT/LUMINARIES SUPPORT
- 37 UTILITY POLE
- 38 OTHER POST, POLE OR SUPPORT
- 39 CULVERT
- 40 CURB
- 41 DITCH
- 42 EMBANKMENT
- 43 FENCE
- 44 MAILBOX
- 45 TREE
- 46 OTHER FIXED OBJECT
- 47 WORKZONE MAINTENANCE EQUIPMENT
- 48 UNKNOWN FIXED OBJECT
- 49 OTHER
- 50 UNKNOWN

- NON-COLLISION**
- 01 OVERTURN/ROLLOVER
  - 02 FIRE/EXPLOSION
  - 03 IMMERSION
  - 04 JACKKNIFE
  - 05 CARGO/EQUIPMENT LOSS/SHIFT
  - 06 EQUIPMENT FAILURE
  - 07 SEPARATION OF UNITS
  - 08 RAN OFF ROAD RIGHT
  - 09 RAN OFF ROAD LEFT
  - 10 CROSS MEDIAN/CENTERLINE
  - 11 DOWNHILL RUNAWAY
  - 12 OTHER NON COLLISION
  - 13 UNKNOWN NON-COLLISION
  - 14 COLLISION W/PERSON, VEHICLE, OR OBJECT NOT FIXED
  - 15 PEDESTRIAN
  - 16 PEDALCYCLE
  - 17 RAILWAY VEHICLE
  - 18 ANIMAL - FARM
  - 19 ANIMAL - DEER
  - 20 ANIMAL - OTHER
  - 21 MOTOR VEHICLE IN TRANSPORT
  - 22 WORK ZONE MAINTENANCE EQUIPMENT
  - 23 OTHER MOVABLE OBJECT
  - 24 UNKNOWN MOVABLE OBJECT
  - 25 COLLISION WITH FIXED OBJECT
  - 26 IMPACT ATTENUATOR/CRASH CUSHION
  - 27 BRIDGE OVERHEAD STRUCTURE
  - 28 BRIDGE PIER OR ABUTMENT
  - 29 BRIDGE PARAPET
  - 30 BRIDGE RAIL
  - 31 GUARDRAIL FACE
  - 32 GUARDRAIL END
  - 33 MEDIAN BARRIER
  - 34 HIGHWAY TRAFFIC SIGN POST
  - 35 OVERHEAD SIGN POST
  - 36 LIGHT/LUMINARIES SUPPORT
  - 37 UTILITY POLE
  - 38 OTHER POST, POLE OR SUPPORT
  - 39 CULVERT
  - 40 CURB
  - 41 DITCH
  - 42 EMBANKMENT
  - 43 FENCE
  - 44 MAILBOX
  - 45 TREE
  - 46 OTHER FIXED OBJECT
  - 47 WORKZONE MAINTENANCE EQUIPMENT
  - 48 UNKNOWN FIXED OBJECT
  - 49 OTHER
  - 50 UNKNOWN

- FIRST HARMFUL EVENT**
- 1
  - 2
  - 3
  - 4
  - 5
  - 6
  - 7
  - 8
  - 9
  - 10
  - 11
  - 12
  - 13
  - 14
  - 15
  - 16
  - 17
  - 18
  - 19
  - 20
  - 21
  - 22
  - 23
  - 24
  - 25
  - 26
  - 27
  - 28
  - 29
  - 30
  - 31
  - 32
  - 33
  - 34
  - 35
  - 36
  - 37
  - 38
  - 39
  - 40
  - 41
  - 42
  - 43
  - 44
  - 45
  - 46
  - 47
  - 48
  - 49
  - 50

FIRST HARMFUL EVENT  
1

- MOST HARMFUL EVENT**
- 1
  - 2
  - 3
  - 4
  - 5
  - 6
  - 7
  - 8
  - 9
  - 10
  - 11
  - 12
  - 13
  - 14
  - 15
  - 16
  - 17
  - 18
  - 19
  - 20
  - 21
  - 22
  - 23
  - 24
  - 25
  - 26
  - 27
  - 28
  - 29
  - 30
  - 31
  - 32
  - 33
  - 34
  - 35
  - 36
  - 37
  - 38
  - 39
  - 40
  - 41
  - 42
  - 43
  - 44
  - 45
  - 46
  - 47
  - 48
  - 49
  - 50

MOST HARMFUL EVENT  
1

- SPEED DETECTED**
- 1 STATED
  - 2 ESTIMATED SPEED

SPEED DETECTED  
1

- SPEED**
- 0
  - 1
  - 2
  - 3
  - 4
  - 5
  - 6
  - 7
  - 8
  - 9
  - 10
  - 11
  - 12
  - 13
  - 14
  - 15
  - 16
  - 17
  - 18
  - 19
  - 20
  - 21
  - 22
  - 23
  - 24
  - 25
  - 26
  - 27
  - 28
  - 29
  - 30
  - 31
  - 32
  - 33
  - 34
  - 35
  - 36
  - 37
  - 38
  - 39
  - 40
  - 41
  - 42
  - 43
  - 44
  - 45
  - 46
  - 47
  - 48
  - 49
  - 50

SPEED  
0 4 5

POSTED SPEED  
5 0

TRAFFIC CONTROL  
1 2

- 01 NO CONTROLS
- 02 STOP SIGN
- 03 YIELD SIGN
- 04 TRAFFIC SIGNAL
- 05 TRAFFIC FLASHERS
- 06 SCHOOL ZONE
- 07 RAILROAD CROSSBUCKS
- 08 RAILROAD FLASHERS
- 09 RAILROAD GATES
- 10 CONSTRUCTION BARRICADE
- 11 POLICE OFFICER
- 12 PAVEMENT MARKINGS
- 13 CROSSWALK LINES
- 14 WALK/DO NOT WALK SIGNAL
- 15 TRAFFIC CONTROL DEVICE INOPERATIVE, MISSING, OBSCURED
- 16 OTHER

DIRECTION  
FROM TO FROM TO  
1 2 3

- 1 NORTH
- 2 SOUTH
- 3 EAST
- 4 WEST
- 5 NORTHEAST
- 6 NORTHWEST
- 7 SOUTHEAST
- 8 SOUTHWEST
- 9 UNKNOWN

CONDITION  
1 2

- 1 APPARENTLY NORMAL
- 2 PHYSICAL IMPAIRMENT
- 3 EMOTIONAL
- 4 ILLNESS
- 5 FELL ASLEEP, FAINTED, FATIGUED, ETC
- 6 UNDER THE INFLUENCE OF MEDICATIONS/DRUGS/ALCOHOL
- 7 OTHER
- 8 UNKNOWN

ALCOHOL/DRUG SUSPECTED  
1

- 1 NONE
- 2 YES - ALCOHOL SUSPECTED
- 3 YES - HBD NOT IMPAIRED
- 4 YES - DRUGS SUSPECTED
- 5 YES - ALCOHOL/ DRUGS SUSPECTED
- 6 UNKNOWN

ALCOHOL TEST STATUS  
1

- 1 NONE
- 2 TEST REFUSED
- 3 TEST GIVEN, CONTAMINATED SAMPLE/UNUSABLE
- 4 TEST GIVEN, RESULTS KNOWN
- 5 TEST GIVEN, RESULTS UNKNOWN
- 6 UNKNOWN

ALCOHOL TEST TYPE  
1

- 1 NONE
- 2 BLOOD
- 3 URINE
- 4 BREATH
- 5 OTHER

ALCOHOL TEST RESULT

DRUG TEST STATUS  
1

- 1 NONE
- 2 TEST REFUSED
- 3 TEST GIVEN, CONTAMINATED SAMPLE/UNUSABLE
- 4 TEST GIVEN, RESULTS KNOWN
- 5 TEST GIVEN, RESULTS UNKNOWN
- 6 UNKNOWN

DRUG TEST TYPE  
1

- 1 NONE
- 2 BLOOD
- 3 URINE
- 4 OTHER

DRUG TEST 1&2 RESULT

- 1 NONE
- 2 MARIJUANA
- 3 COCAINE
- 4 OPIATES
- 5 AMPHETAMINES
- 6 PCP
- 7 OTHERS
- 8 UNKNOWN AT TIME OF REPORTING

TYPE OF INTERSECTION  
0 1

- 01 NOT AN INTERSECTION
- 02 FOUR-WAY INTERSECTION
- 03 T-INTERSECTION
- 04 Y-INTERSECTION
- 05 TRAFFIC CIRCLE/ROUNDABOUT
- 06 FIVE-POINT, OR MORE
- 07 ON RAMP
- 08 OFF RAMP
- 09 CROSSOVER
- 10 DRIVEWAY/ACCESS
- 11 RAILWAY GRADE CROSSING
- 12 SHARED-USE PATHS OR TRAILS
- 13 UNKNOWN

OCCURRENCE  
1

- 1 ON ROADWAY
- 2 ON SHOULDER
- 3 IN MEDIAN
- 4 ON ROADSIDE
- 5 ON GORE
- 6 OUTSIDE TRAFFICWAY
- 7 UNKNOWN

ROAD CONTOUR  
1

- 1 STRAIGHT LEVEL
- 2 STRAIGHT GRADE
- 3 CURVE LEVEL
- 4 CURVE GRADE

ROAD CONDITIONS  
0 1

- 01 DRY
- 02 WET
- 03 SNOW
- 04 ICE
- 05 SAND, MUD, DIRT, OIL, GRAVEL
- 06 WATER (STANDING, MOVING)
- 07 SLUSH
- 08 DEBRIS \*\*
- 09 RUT, HOLES, BUMPS, UNEVEN PAVEMENT\*\*
- 10 OTHER
- 11 UNKNOWN
- \*\* SECONDARY ROAD CONDITIONS ONLY

10 - 030

**Narrative**

UNIT #1 WAS TRAVELING SOUTHBOUND ON FREDERICK PIKE IN THE SOUTHBOUND LANE AND WHEN AT APPROXIMATELY FEET SOUTH OF 10016 FREDERICK PIKE, UNIT #1 STRUCK A DEER THAT WAS TRAVELING EAST TO WEST ACROSS THE ROAD.

**Diagram**

**SEE OH-2  
FOR DIAGRAM**

**MANNER OF COLLISION OR IMPACT**

1  
1 NOT COLLISION BETWEEN TWO VEHICLES IN TRANSPORT  
2 REAR-END  
3 HEAD-ON  
4 REAR-TO-REAR  
5 BACKING  
6 ANGLE  
7 SIDESWIPE, SAME DIRECTION  
8 SIDESWIPE, OPPOSITE DIRECTION  
9 UNKNOWN

**SCHOOL BUS RELATED**

1  
1 NO  
2 YES, DIRECTLY INVOLVED  
3 YES, INDIRECTLY INVOLVED  
4 UNKNOWN

**WORK ZONE RELATED**

1  
1 NO  
2 YES  
3 UNKNOWN

**TYPE OF WORK ZONE**

1  
1 LANE CLOSURE  
2 LANE SHIFT/CROSSOVER  
3 WORK ON SHOULDER OR MEDIAN  
4 INTERMITTENT/ MOVING WORK  
5 OTHER

**LOCATION OF CRASH IN WORK ZONE**

1  
1 BEFORE FIRST WORK ZONE WARNING SIGN  
2 ADVANCE WARNING AREA  
3 TRANSITION AREA  
4 ACTIVITY AREA

**WORKERS PRESENT**

1  
1 NO  
2 YES  
3 UNKNOWN

**WEATHER**

0  2  
01 CLEAR  
02 CLOUDY  
03 FOG, SMOG, SMOKE  
04 RAIN  
05 SLEET, HAIL, (FREEZING RAIN DRIZZLE)  
06 SNOW  
07 SEVERE CROSSWINDS  
08 BLOWING SAND, SOIL, DIRT, SNOW  
09 OTHER  
10 UNKNOWN

**LIGHT CONDITIONS**

2   
1 DAYLIGHT  
2 DAWN  
3 DUSK  
4 DARK - LIGHTED ROADWAY  
5 DARK - NOT LIGHTED  
6 DARK - UNKNOWN LIGHTING  
7 GLARE  
8 OTHER  
9 UNKNOWN

**Truck/Bus**

THE CRASH INVOLVED ONE OR MORE OF THE FOLLOWING:  
A TRUCK (MOTOR VEHICLE) WITH A GVWR MORE THAN 10,000 POUNDS; OR  
A TRUCK (MOTOR VEHICLE) WITH A HAZARDOUS MATERIALS PLACARD; OR  
A BUS DESIGNED FOR AT LEAST 8 PERSONS, INCLUDING DRIVER.

**A** THE CRASH RESULTED IN ONE OR MORE OF THE FOLLOWING:  
**N** A FATALITY; OR  
**D** AN INJURY REQUIRING TRANSPORTATION FOR IMMEDIATE MEDICAL TREATMENT, OR  
AT LEAST ONE VEHICLE WAS TOWED DUE TO DISABLING DAMAGE OR REQUIRED INTERVENING ASSISTANCE BEFORE PROCEEDING UNDER ITS OWN POWER

COMPANY (FROM SHIPPING PAPERS)

COMPANY PHONE

ADDRESS (STREET, CITY, ST, ZIP CODE)

US DOT:  ICC MC:  PLUCO:  TRAILER LP ST:  TRAILER LP YEAR:  TRAILER LP #:  PLACARD #:  # OF AXLES:

CARGO BODY TYPE:  01 NOT APPLICABLE,  02 BUS (8-15 INCLUDING DRIVER),  03 VAN/ENCLOSED BOX,  04 GRAIN/CHIPS/GRAVEL,  05 POLE,  06 CARGO TANK,  07 FLATBED,  08 DUMP,  09 CONCRETE MIXER,  10 AUTO TRANSPORTER,  11 GARBAGE/REFUSE,  12 OTHER,  13 UNKNOWN

Weight (GVWR):  1 LESS/EQUAL 10,000,  2 10,001-28,000,  3 MORE THAN 28,000

CDL Class:  1 CLASS A,  2 CLASS B,  3 CLASS C,  4 CLASS M,  6 CLASS D

Hazardous Materials Placard:  1 NO,  2 YES,  3 UNKNOWN

Hazardous Materials Released:  1 NO,  2 YES,  3 NOT APPLICABLE,  4 UNKNOWN

**Police Action**

DATE CRASH REPORTED: 0 2 1 8 2 0 1 0 TIME REC CALL: 0 7 2 6 DISPATCH: 0 7 4 0 ARRIVED: 0 7 5 2 CLEARED: 0 8 2 0 OTHER: 0 0 2 0 TOTAL MINUTES: 6 0

OFFICER'S NAME: SERGEANT M. MORGAN BADGE #: 5 CHECKED BY: CHIEF D. HOBBS DATE REPORT FILED: 0 2 1 8 2 0 1 0

REPORT TAKEN BY:  1 POLICE AGENCY,  2 MOTORIST REPORT TAKEN AT:  1 SCENE,  2 STATION,  3 OTHER SUPPLEMENT:  X IF YES LOCAL REPORTS: 1 0 - 0 3 0



LOCAL REPORT NUMBER <b>10-030</b>	REPORTING AGENCY <b>BUTLER TOWNSHIP POLICE DEPT.</b>	DATE OF CRASH <b>MOR 10/18/10</b>
IN COUNTY OF <b>MONTGOMERY</b>	CRASH LOCATION <b>FREDERICK PK. @ 75 FEET SOUTH OF 10016 FREDERICK PK.</b>	

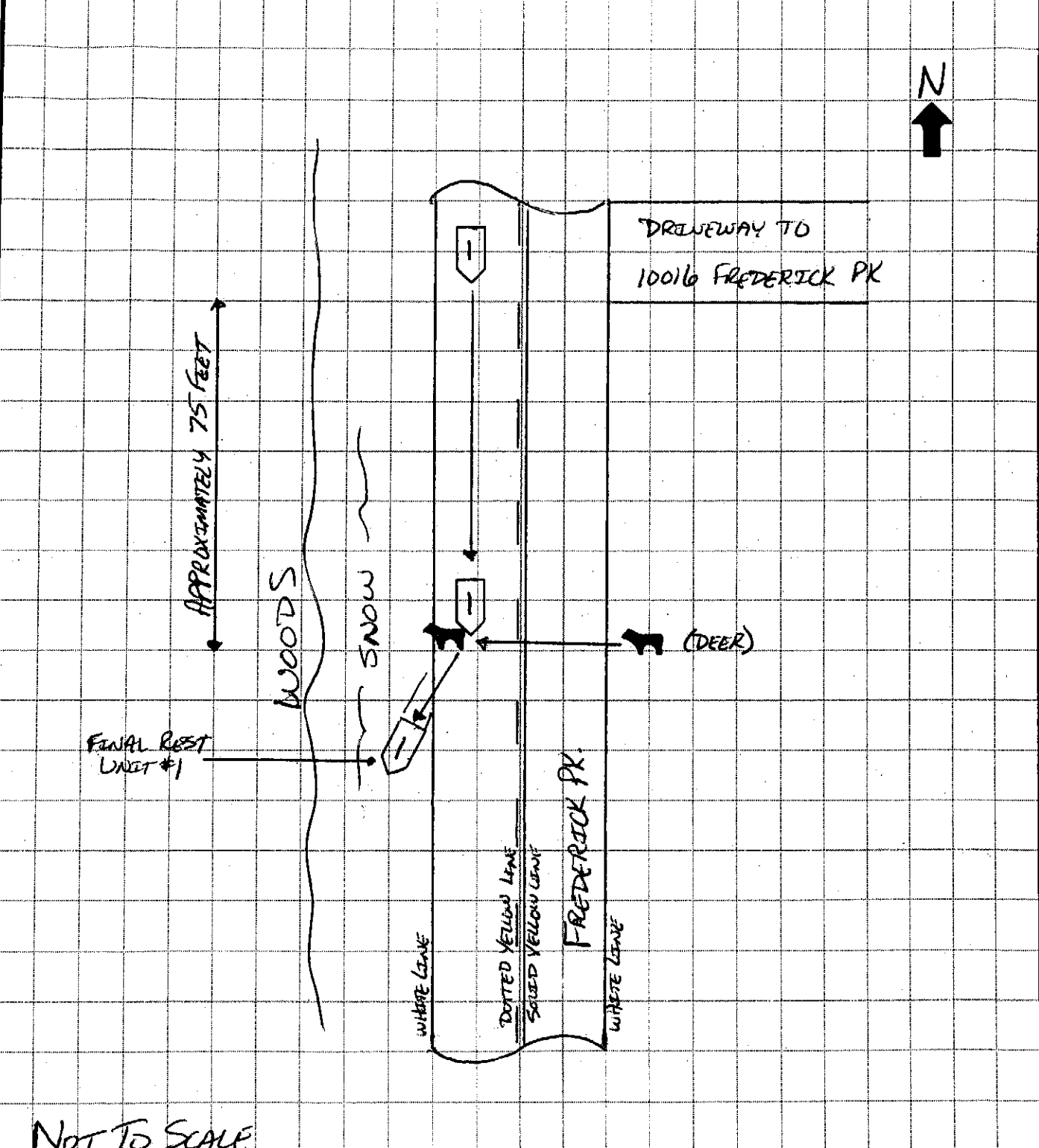

NOT TO SCALE

OFFICER'S SIGNATURE <b>X SGT. M.D. Morgan #5</b>	BADGE NUMBER <b>5</b>
---	--------------------------