

# TRAFFIC CRASH REPORT



LOCAL REPORT #\*  
1 0 - 0 1 7

CRASH SEVERITY  
3 1 FATAL 3 PDO  
2 INJURY 4 UNKNOWN

PRIVATE PROPERTY  
IF YES

HIT/SKIP  
1 NOT HIT/SKIP  
2 SOLVED  
3 UNSOLVED

PHOTOS TAKEN  
OH-2 OH-3 OH-1P OTHER

MEDIC #\*  
0 5 7 2 4

REPORTING AGENCY\*  
BUTLER TOWNSHIP POLICE DEPT.

# UNITS  
0 1

UNIT ERROR  
9 8 98 = ANIMAL  
99 = UNKNOWN

DATE OF CRASH\*  
0 1 2 4 2 0 1 0

TYPE OF CRASH DAY OF WEEK CITY\* VILLAGE\* TWP\* NAME (OF CITY, VILLAGE OR TOWNSHIP)\* COUNTY #\* LATITUDE LONGITUDE  
1 5 2 5 SUN BUTLER (TOWNSHIP OF) 5 7

CRASH LOCATION PREFIX CRASH LOCATION TYPE LOC TYPE LOCATION POINT USED  
W NATIONAL ROAD 1 1 NAMED STREET 3 NUMBERED ROUTE  
2 NUMBERED STREET

REFERENCE POINT USED 04 HOUSE NUMBER 08 PLACE NAME AND REFERENCE  
01 STATE LINE 05 TOWNSHIP BOUNDARY 09 DRIVEWAY  
02 INTERSECTION 2 STREETS 06 MILE POST 10 STREET OR ROUTE  
03 COUNTY LINE 07 CORPORATE LIMIT 11 RAILROAD

UNIT # # OF OCC. NAME (LAST, FIRST, MIDDLE)  
0 1 0 1 MOORE JOHNNIE S

ADDRESS (STREET, CITY, STATE, ZIP CODE)  
506 WINTERGREEN PLACE CLAYTON OH 45315

SOCIAL SECURITY NUMBER DATE OF BIRTH AGE SEX HOME PHONE# WORK PHONE#  
0 7 2 9 1 9 7 1 3 8 M 937-854-0950 937-673-0962

DL STATE DL# LP STATE LP# INJURED TAKEN BY 1 NONE 4 OTHER TRANSPORTED BY INJURED TAKEN TO  
OH RN739999 OH PGB2263 2 EMS 5 UNKNOWN

OWNER NAME (IF SAME, WRITE "SAME") ADDRESS (STREET, CITY, STATE, ZIP CODE)  
BUCKEYE OIL EQUIPMENT 4377 OLD SPRINGFIELD ROAD VANDALIA OH 45377

YEAR MAKE MODEL COLOR INSURANCE COMPANY TOWING SERVICE OWNER PHONE #  
2 0 0 7 CHEVROLEY 3500 HD WHITE RIVERBEND INSURANCE CO 800-875-8236

OFFENSE CHARGED OFFENSE DESCRIPTION CITATION # LOCAL CODE#  
X IF YES

UNIT # # OF OCC. NAME (LAST, FIRST, MIDDLE)

ADDRESS (STREET, CITY, STATE, ZIP CODE)

SOCIAL SECURITY NUMBER DATE OF BIRTH AGE SEX HOME PHONE # WORK PHONE #

DL STATE DL# LP STATE LP# INJURED TAKEN BY 1 NONE 4 OTHER TRANSPORTED BY INJURED TAKEN TO

OWNER NAME (IF SAME, WRITE "SAME") ADDRESS (STREET, CITY, STATE, ZIP CODE)

YEAR MAKE MODEL COLOR INSURANCE COMPANY TOWING SERVICE OWNER PHONE #

OFFENSE CHARGED OFFENSE DESCRIPTION CITATION # LOCAL CODE#  
X IF YES

LICIT # NAME(LAST, FIRST,MIDDLE) HOME PHONE # DATE OF BIRTH AGE SEX

ADDRESS (STREET, CITY, STATE, ZIP CODE) INJURED TAKEN BY 1 NONE 4 OTHER TRANSPORTED BY INJURED TAKEN TO  
2 EMS 5 UNKNOWN 3 POLICE

LICIT # NAME(LAST, FIRST,MIDDLE) HOME PHONE # DATE OF BIRTH AGE SEX

ADDRESS (STREET, CITY, STATE, ZIP CODE) INJURED TAKEN BY 1 NONE 4 OTHER TRANSPORTED BY INJURED TAKEN TO  
2 EMS 5 UNKNOWN 3 POLICE

MOTORIST/MOTORIST

Occupant

0 1 SEATING POSITION 01 FRONT - LEFT (MC DRIVER) 02 FRONT - MIDDLE 03 FRONT - RIGHT 04 SECOND - LEFT (MC PASS) 05 SECOND - MIDDLE 06 SECOND - RIGHT 07 THIRD - LEFT (MC PASSENGER/SIDE CAR) 08 THIRD - MIDDLE 09 THIRD - RIGHT 10 SLEEPER SECTION OF CAB 11 ENCLOSED CARGO AREA 12 UNENCLOSED CARGO AREA 13 TRAILING UNIT 14 EXTERIOR 15 OTHER 16 NON-MOTORIST 17 UNKNOWN	0 4 SAFETY EQUIPMENT MOTORIST 01 NONE USED 02 SHOULDER BELT ONLY 03 LAP BELT ONLY 04 SHOULDER/LAP BELT 05 CHILD SAFETY SEAT 06 MC HELMET USED 07 USE UNKNOWN NON-MOTORIST 08 NONE USED 09 HELMET USED 10 PROTECTIVE PADS 11 REFLECTIVE CLOTHING 12 LIGHTING 13 OTHER 14 UNKNOWN	1 A AIR BAG 1 NOT-DEPLOYED 2 DEPLOYED-FRONT 3 DEPLOYED-SIDE 4 DEPLOYED BOTH FRONT/SIDE 5 NOT APPLICABLE 8 UNKNOWN	1 A AIR BAG SWITCH 1 NOT PRESENT 2 IN ON POSITION 3 IN OFF POSITION 4 UNKNOWN	1 A EJECTION 1 NOT EJECTED 2 TOTALLY EJECTED 3 PARTIALLY EJECTED 4 NOT APPLICABLE 5 UNKNOWN	1 A TRAPPED 1 NOT TRAPPED 2 EXTRICATED BY MECHANICAL MEANS 3 FREED BY NON-MECHANICAL MEANS 4 UNKNOWN	1 A INJURIES 1 NO INJURY 2 POSSIBLE 3 NON-INCAPACITATING 4 INCAPACITATING 5 FATAL INJURY 6 UNKNOWN
--	--	---	--	---	---	---

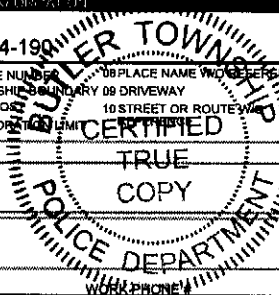

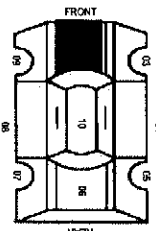
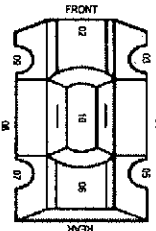
<b>UNIT NUMBERS</b> <input type="text" value="0"/> <input type="text" value="1"/> <input type="text"/> <input type="text"/> <b>NON-MOTORIST LOCATION</b> <input type="text"/> <input type="text"/> <input type="text"/> <input type="text"/> 01 MARKED CROSSWALK AT INTERSECTION 02 INTERSECTION/NO CROSSWALK 03 NON-INTERSECTION CROSSWALK 04 DRIVEWAY ACCESS CROSSWALK 05 IN ROADWAY 06 NOT IN ROADWAY 07 MEDIAN (BUT NOT SHOULDER) 08 ISLAND 09 SHOULDER 10 SIDEWALK 11 WITHIN 10 FEET OF ROADWAY (NOT SHOULDER, MEDIAN, SIDEWALK, ISLAND) 12 BEYOND 10 FEET OF ROADWAY (WITHIN TRAFFICWAY) 13 OUTSIDE TRAFFICWAY 14 SHARED USE PATHS OR TRAILS 15 UNKNOWN	<b>DAMAGE AREA</b>   <b>MOST DAMAGED AREA</b> <input type="text" value="0"/> <input type="text" value="2"/> <input type="text"/> <input type="text"/> 01 NONE 02 CENTER FRONT 03 RIGHT FRONT 04 RIGHT SIDE 05 RIGHT REAR 06 REAR CENTER 07 LEFT REAR 08 LEFT SIDE 09 LEFT FRONT 10 TOP AND WINDOWS 11 UNDERCARRIAGE 12 LOAD/TRAILER 13 TOTAL (ALL AREAS) 14 OTHER 15 UNKNOWN	<b>PRE-CRASH ACTIONS</b> <input type="text" value="0"/> <input type="text" value="1"/> <input type="text"/> <input type="text"/> <b>MOTORIST</b> 01 MOVEMENTS ESSENTIALLY STRAIGHT AHEAD 02 BACKING 03 CHANGING LANES 04 OVERTAKING/PASSING 05 TURNING RIGHT 06 TURNING LEFT 07 MAKING U-TURN 08 ENTERING TRAFFIC LANE 09 LEAVING TRAFFIC LANE 10 PARKED 11 SLOWING/STOPPED IN TRAFFIC 12 DRIVERLESS 13 OTHER 14 UNKNOWN <b>NON-MOTORIST</b> 15 ENTERING/CROSSING IN SPECIFIED LOCATION 16 WALKING, RUNNING, JOGGING, PLAYING, CYCLING 17 WORKING 18 PUSHING VEHICLE 19 APPROACHING/LEAVING VEHICLE 20 PLAYING/WORKING ON VEHICLE 21 STANDING 22 OTHER 23 UNKNOWN	<b>SEQUENCE OF EVENTS</b> <table border="1" style="width:100%; border-collapse: collapse;"> <tr> <td style="width:50%;"><input type="text" value="1"/> <input type="text" value="8"/> <input type="text"/> <input type="text"/></td> <td style="width:50%;"><input type="text"/> <input type="text"/> <input type="text"/> <input type="text"/></td> </tr> <tr> <td><input type="text"/> <input type="text"/> <input type="text"/> <input type="text"/></td> <td><input type="text"/> <input type="text"/> <input type="text"/> <input type="text"/></td> </tr> <tr> <td><input type="text"/> <input type="text"/> <input type="text"/> <input type="text"/></td> <td><input type="text"/> <input type="text"/> <input type="text"/> <input type="text"/></td> </tr> <tr> <td><input type="text"/> <input type="text"/> <input type="text"/> <input type="text"/></td> <td><input type="text"/> <input type="text"/> <input type="text"/> <input type="text"/></td> </tr> </table> <b>NON-COLLISION</b> 01 OVERTURN/Rollover 02 FIRE/EXPLOSION 03 IMMERSION 04 JACKKNIFE 05 CARGO/EQUIPMENT LOSS/SHIFT 06 EQUIPMENT FAILURE 07 SEPARATION OF UNITS 08 RAN OFF ROAD RIGHT 09 RAN OFF ROAD LEFT 10 CROSS MEDIAN/CENTERLINE 11 DOWNHILL RUNAWAY 12 OTHER NON-COLLISION 13 UNKNOWN NON-COLLISION <b>COLLISION W/PERSON, VEHICLE, OR OBJECT NOT FIXED</b> 14 PEDESTRIAN 15 PEDALCYCLE 16 RAILWAY VEHICLE 17 ANIMAL - FARM 18 ANIMAL - DEER 19 ANIMAL - OTHER 20 MOTOR VEHICLE IN TRANSPORT 21 PARKED MOTOR VEHICLE 22 WORK ZONE MAINTENANCE EQUIPMENT 23 OTHER MOVABLE OBJECT 24 UNKNOWN MOVABLE OBJECT <b>COLLISION WITH FIXED OBJECT</b> 25 IMPACT ATTENUATOR/CRASH CUSHION 26 BRIDGE OVERHEAD STRUCTURE 27 BRIDGE PIER OR ABUTMENT 28 BRIDGE RAPRAPE 29 BRIDGE RAIL 30 GUARDRAIL FACE 31 GUARDRAIL END 32 MEDIAN BARRIER 33 HIGHWAY TRAFFIC SIGN POST 34 OVERHEAD SIGN PDST 35 LIGHT/LUMINARIES SUPPORT 36 UTILITY POLE 37 OTHER POST, POLE OR SUPPORT 38 CULVERT 39 CURB 40 DITCH 41 EMBANKMENT 42 FENCE 43 MAILBOX 44 TREE 45 OTHER FIXED OBJECT 46 WORKZONE MAINTENANCE EQUIPMENT 47 UNKNOWN FIXED OBJECT 48 OTHER 49 UNKNOWN	<input type="text" value="1"/> <input type="text" value="8"/> <input type="text"/> <input type="text"/>	<input type="text"/> <input type="text"/> <input type="text"/> <input type="text"/>	<input type="text"/> <input type="text"/> <input type="text"/> <input type="text"/>	<input type="text"/> <input type="text"/> <input type="text"/> <input type="text"/>	<input type="text"/> <input type="text"/> <input type="text"/> <input type="text"/>	<input type="text"/> <input type="text"/> <input type="text"/> <input type="text"/>	<input type="text"/> <input type="text"/> <input type="text"/> <input type="text"/>	<input type="text"/> <input type="text"/> <input type="text"/> <input type="text"/>	<b>POSTED SPEED</b> <input type="text" value="5"/> <input type="text" value="5"/> <input type="text"/> <input type="text"/> <b>TRAFFIC CONTROL</b> <input type="text" value="1"/> <input type="text" value="2"/> <input type="text"/> <input type="text"/> 01 NO CONTROLS 02 STOP SIGN 03 YIELD SIGN 04 TRAFFIC SIGNAL 05 TRAFFIC FLASHERS 06 SCHOOL ZONE 07 RAILROAD CROSSBUCKS 08 RAILROAD FLASHERS 09 RAILROAD GATES 10 CONSTRUCTION BARRICADE 11 POLICE OFFICER 12 PAVEMENT MARKINGS 13 CROSSWALK LINES 14 WALK/DONT WALK SIGNAL 15 TRAFFIC CONTROL DEVICE INOPERATIVE, MISSING, OBSCURED 16 OTHER <b>DIRECTION</b> <table border="1" style="width:100%; border-collapse: collapse;"> <tr> <td style="width:50%;"><input type="text" value="4"/> <input type="text" value="3"/> <input type="text"/> <input type="text"/></td> <td style="width:50%;"><input type="text"/> <input type="text"/> <input type="text"/> <input type="text"/></td> </tr> <tr> <td>FROM TO</td> <td>FROM TO</td> </tr> </table> 1 NORTH 2 SOUTH 3 EAST 4 WEST 5 NORTHEAST 6 NORTHWEST 7 SOUTHEAST 8 SOUTHWEST 9 UNKNOWN	<input type="text" value="4"/> <input type="text" value="3"/> <input type="text"/> <input type="text"/>	<input type="text"/> <input type="text"/> <input type="text"/> <input type="text"/>	FROM TO	FROM TO	<b>DRUG TEST STATUS</b> <input type="text" value="1"/> <input type="text"/> <input type="text"/> <input type="text"/> 1 NONE 2 TEST REFUSED 3 TEST GIVEN, CONTAMINATED SAMPLE/UNUSABLE 4 TEST GIVEN, RESULTS KNOWN 5 TEST GIVEN, RESULTS UNKNOWN 6 UNKNOWN <b>DRUG TEST TYPE</b> <input type="text" value="1"/> <input type="text"/> <input type="text"/> <input type="text"/> 1 NONE 2 BLOOD 3 URINE 4 OTHER <b>DRUG TEST 1&amp;2 RESULT</b> <table border="1" style="width:100%; border-collapse: collapse;"> <tr> <td style="width:50%;"><input type="text"/> <input type="text"/> <input type="text"/> <input type="text"/></td> <td style="width:50%;"><input type="text"/> <input type="text"/> <input type="text"/> <input type="text"/></td> </tr> <tr> <td>1 2</td> <td>1 2</td> </tr> </table> 1 NONE 2 MARIJUANA 3 COCAINE 4 OPIATES 5 AMPHETAMINES 6 PCP 7 OTHERS 8 UNKNOWN AT TIME OF REPORTING	<input type="text"/> <input type="text"/> <input type="text"/> <input type="text"/>	<input type="text"/> <input type="text"/> <input type="text"/> <input type="text"/>	1 2	1 2
<input type="text" value="1"/> <input type="text" value="8"/> <input type="text"/> <input type="text"/>	<input type="text"/> <input type="text"/> <input type="text"/> <input type="text"/>																				
<input type="text"/> <input type="text"/> <input type="text"/> <input type="text"/>	<input type="text"/> <input type="text"/> <input type="text"/> <input type="text"/>																				
<input type="text"/> <input type="text"/> <input type="text"/> <input type="text"/>	<input type="text"/> <input type="text"/> <input type="text"/> <input type="text"/>																				
<input type="text"/> <input type="text"/> <input type="text"/> <input type="text"/>	<input type="text"/> <input type="text"/> <input type="text"/> <input type="text"/>																				
<input type="text" value="4"/> <input type="text" value="3"/> <input type="text"/> <input type="text"/>	<input type="text"/> <input type="text"/> <input type="text"/> <input type="text"/>																				
FROM TO	FROM TO																				
<input type="text"/> <input type="text"/> <input type="text"/> <input type="text"/>	<input type="text"/> <input type="text"/> <input type="text"/> <input type="text"/>																				
1 2	1 2																				
<b>TYPE OF UNIT</b> <input type="text" value="0"/> <input type="text" value="7"/> <input type="text"/> <input type="text"/> <b>MOTORIST</b> 01 SUB-COMPACT 02 COMPACT 03 MID SIZE 04 FULL SIZE 05 MINIVAN 06 SPORT UTILITY VEHICLE 07 PICKUP 08 PANELVAN 09 SINGLE UNIT TRUCK; 2 AXLES, 6 TIRES 10 SINGLE UNIT TRUCK; 3+ AXLES 11 TRUCK/TRAILER 12 TRUCK TRACTOR (BOBTAIL) 13 TRACTOR/SEMI-TRAILER 14 TRACTOR/DOUBLE SHORT 15 TRACTOR/DOUBLE LONG 16 FIFTH WHEEL OR CONVERTER DOLLY 17 TRACTOR/TRIPLES 18 MOTORCYCLE 19 MOTORIZED BICYCLE 20 SCHOOL BUS 21 CHURCH BUS 22 PUBLIC BUS 23 OTHER BUS 24 POLICE VEHICLE 25 FIRE TRUCK 26 AMBULANCE/RESCUE 27 TAXI 28 MOTOR HOME 29 TRAIN 30 FARM VEHICLE 31 FARM EQUIPMENT 32 SNOWMOBILE 33 CONSTRUCTION EQUIPMENT 34 ALL OTHERS <b>NON-MOTORIST</b> 35 ANIMAL WRIDER 36 ANIMAL W/BUGGY 37 BICYCLE 38 PEDESTRIAN 39 PEDALCYCLIST 40 SKATER 41 OTHER NON-MOTORIST 42 UNKNOWN	<b>CONTRIBUTING CIRCUMSTANCES</b> <input type="text" value="0"/> <input type="text" value="1"/> <input type="text"/> <input type="text"/> <b>MOTORIST</b> 01 NONE 02 FAILURE TO YIELD 03 RAN RED LIGHT, OR STOP SIGN 04 EXCEEDED SPEED LIMIT 05 UNSAFE SPEED 06 IMPROPER TURN 07 LEFT OF CENTER 08 FOLLOWED TOO CLOSELY/ACDA 09 IMPROPER LANE CHANGE/ DROVE OFF ROAD/ IMPROPER PASSING 10 IMPROPER BACKING 11 IMPROPER START FROM PARKED POSITION 12 STOPPED OR PARKED ILLEGALLY 13 OPERATING VEHICLE IN ERRATIC, RECKLESS, CARELESS, NEGLIGENT OR AGGRESSIVE MANNER 14 SWERVING TO AVOID (DUE TO WIND, SLIPPERY SURFACE, VEHICLE, OBJECT, NON-MOTORIST IN ROADWAY, ETC) 15 FAILURE TO CONTROL 16 VISION OBSTRUCTION 17 DRIVER INATTENTION 18 FATIGUE/ASLEEP 19 OPERATING DEFECTIVE EQUIPMENT 20 LOAD SHIFTING/FALLING/SPILLING 21 OTHER IMPROPER ACTION 22 UNKNOWN <b>NON-MOTORIST</b> 23 NONE 24 IMPROPER CROSSING 25 DARTING 26 LYING AND/OR ILLEGALLY IN ROADWAY 27 FAILURE TO YIELD RIGHT OF WAY 28 NOT VISIBLE (DARK CLOTHING) 29 INATTENTIVE 30 FAILURE TO OBEY TRAFFIC SIGNS, SIGNALS, OR OFFICER 31 WRONG SIDE OF THE ROAD 32 OTHER 33 UNKNOWN	<b>CONDITION</b> <input type="text" value="1"/> <input type="text"/> <input type="text"/> <input type="text"/> 1 APPARENTLY NORMAL 2 PHYSICAL IMPAIRMENT 3 EMOTIONAL 4 ILLNESS 5 FELL ASLEEP, FAINTED, FATIGUED, ETC 6 UNDER THE INFLUENCE OF MEDICATIONS/DRUGS/ALCOHOL 7 OTHER 8 UNKNOWN <b>ALCOHOL/DRUG SUSPECTED</b> <input type="text" value="1"/> <input type="text"/> <input type="text"/> <input type="text"/> 1 NONE 2 YES - ALCOHOL SUSPECTED 3 YES - HBD NOT IMPAIRED 4 YES - DRUGS SUSPECTED 5 YES - ALCOHOL/ DRUGS SUSPECTED 6 UNKNOWN <b>ALCOHOL TEST STATUS</b> <input type="text" value="1"/> <input type="text"/> <input type="text"/> <input type="text"/> 1 NONE 2 TEST REFUSED 3 TEST GIVEN, CONTAMINATED SAMPLE/UNUSABLE 4 TEST GIVEN, RESULTS KNOWN 5 TEST GIVEN, RESULTS UNKNOWN 6 UNKNOWN <b>ALCOHOL TEST TYPE</b> <input type="text" value="1"/> <input type="text"/> <input type="text"/> <input type="text"/> 1 NONE 2 BLOOD 3 URINE 4 BREATH 5 OTHER <b>ALCOHOL TEST RESULT</b> <input type="text"/> <input type="text"/> <input type="text"/> <input type="text"/> <input type="text"/> <input type="text"/> <input type="text"/> <input type="text"/>	<b>TYPE OF INTERSECTION</b> <input type="text" value="0"/> <input type="text" value="1"/> <input type="text"/> <input type="text"/> 01 NOT AN INTERSECTION 02 FOUR-WAY INTERSECTION 03 T-INTERSECTION 04 Y-INTERSECTION 05 TRAFFIC CIRCLE/ROUNDBOUT 06 FIVE-POINT, OR MORE 07 ON RAMP 08 OFF RAMP 09 CROSSOVER 10 DRIVEWAY/ACCESS 11 RAILWAY GRADE CROSSING 12 SHARED-USE PATHS OR TRAILS 13 UNKNOWN <b>OCCURRENCE</b> <input type="text" value="1"/> <input type="text"/> <input type="text"/> <input type="text"/> 1 ON ROADWAY 2 ON SHOULDER 3 IN MEDIAN 4 ON ROADSIDE 5 ON GORE 6 OUTSIDE TRAFFICWAY 7 UNKNOWN <b>ROAD CONTOUR</b> <input type="text" value="2"/> <input type="text"/> <input type="text"/> <input type="text"/> 1 STRAIGHT LEVEL 2 STRAIGHT GRADE 3 CURVE LEVEL 4 CURVE GRADE <b>ROAD CONDITIONS</b> PRIMARY SECONDARY <input type="text" value="0"/> <input type="text" value="2"/> <input type="text"/> <input type="text"/> 01 DRY 02 WET 03 SNOW 04 ICE 05 SAND, MUD, DIRT, OIL, GRAVEL 06 WATER (STANDING, MOVING) 07 SLUSH 08 DEBRIS ** 09 RUT, HOLES, BUMPS, UNEVEN PAVEMENT** 10 OTHER 11 UNKNOWN ** SECONDARY ROAD CONDITIONS ONLY																		
<b>IN EMERGENCY RESPONSE</b> <input type="text"/> <input type="text"/> <input type="text"/> <input type="text"/> 1 NO 2 YES 3 UNKNOWN <b>DAMAGE SCALE</b> <input type="text" value="3"/> <input type="text"/> <input type="text"/> <input type="text"/> 1 NONE 2 NON-FUNCTIONAL DAMAGE 3 FUNCTIONAL DAMAGE 4 DISABLING DAMAGE 5 SEVERE 6 UNKNOWN	<b>ACTION</b> <input type="text" value="3"/> <input type="text"/> <input type="text"/> <input type="text"/> 1 NON-CONTACT 2 NON-COLLISION 3 STRIKING 4 STRUCK 5 BOTH STRIKING AND STRUCK 6 UNKNOWN <b>STRIKING VEHICLE: OVERRIDE/ UNDERRIDE</b> <input type="text" value="1"/> <input type="text"/> <input type="text"/> <input type="text"/> 1 NO UNDERRIDE OR OVERRIDE 2 UNDERRIDE, COMPARTMENT INTRUSION 3 UNDERRIDE, NO COMPARTMENT INTRUSION 4 UNDERRIDE, COMPARTMENT INTRUSION UNKNOWN 5 OVERRIDE, MOTOR VEHICLE IN TRANSPORT 6 OVERRIDE, OTHER VEHICLE 7 UNKNOWN	<b>VEHICLE DEFECT CODE ONLY IF '19' SELECTED ABOVE</b> <input type="text"/> <input type="text"/> <input type="text"/> <input type="text"/> 01 TURN SIGNALS 02 HEAD LAMPS 03 TAIL LAMPS 04 BRAKES 05 STEERING 06 TIRE BLOWOUT 07 WORN OR SLICK TIRES 08 TRAILER EQUIPMENT DEFECTS 09 MOTOR TROUBLE 10 DISABLED FROM PRIOR CRASH 11 OTHER DEFECTS	<b>FIRST HARMFUL EVENT</b> <input type="text" value="1"/> <input type="text"/> <input type="text"/> <input type="text"/> OF THE SEQUENCE OF EVENTS - WHICH ONE IS THE FIRST HARMFUL EVENT (1 - 4) <b>MOST HARMFUL EVENT</b> <input type="text" value="1"/> <input type="text"/> <input type="text"/> <input type="text"/> OF THE SEQUENCE OF EVENTS - WHICH ONE IS THE MOST HARMFUL EVENT (1 - 4) <b>SPEED DETECTED</b> <input type="text" value="1"/> <input type="text"/> <input type="text"/> <input type="text"/> 1 STATED 2 ESTIMATED SPEED <b>SPEED</b> <input type="text" value="0"/> <input type="text" value="5"/> <input type="text" value="5"/> <input type="text"/> <input type="text"/> <input type="text"/> <input type="text"/> <input type="text"/>	<b>SUPPLEMENTAL</b> <input type="checkbox"/> YES <b>LEGAL REPORT #</b> <input type="text" value="1"/> <input type="text" value="0"/> <input type="text" value="0"/> <input type="text" value="1"/> <input type="text" value="7"/> <input type="text"/> <input type="text"/> <input type="text"/>																	

**Narrative**

UNIT #1 WAS TRAVELING EAST ON WEST NATIONAL ROAD (US 40) AND WHEN IN THE AREA OF 3318 WEST NATIONAL ROAD UNIT #1 STRUCK A WHITE TAIL BUCK DEER THAT RAN INTO THE ROADWAY TRAVELING SOUTH TO NORTH KILLING THE DEER AND CAUSING DAMAGE TO UNIT #1

**Diagram**

**SEE OH-2  
FOR DIAGRAM**

<b>MANNER OF COLLISION OR IMPACT</b> <input type="checkbox"/> 1 1 NOT COLLISION BETWEEN TWO VEHICLES IN TRANSPORT 2 REAR-END 3 HEAD-ON 4 REAR-TO-REAR 5 BACKING 6 ANGLE 7 SIDESWIPE, SAME DIRECTION 8 SIDESWIPE, OPPOSITE DIRECTION 9 UNKNOWN	<b>SCHOOL BUS RELATED</b> <input type="checkbox"/> 1 1 NO 2 YES, DIRECTLY INVOLVED 3 YES, INDIRECTLY INVOLVED 4 UNKNOWN
<b>WEATHER</b> <input type="checkbox"/> 0 <input type="checkbox"/> 2 01 CLEAR 02 CLOUDY 03 FOG, SMOG, SMOKE 04 RAIN 05 SLEET, HAIL, (FREEZING RAIN DRIZZLE) 06 SNOW 07 SEVERE CROSSWINDS 08 BLOWING SAND, SOIL, DIRT, SNOW 09 OTHER 10 UNKNOWN	<b>WORK ZONE RELATED</b> <input type="checkbox"/> 1 1 NO 2 YES 3 UNKNOWN
<b>LIGHT CONDITIONS</b> PRIMARY <input type="checkbox"/> 1 <input type="checkbox"/> SECONDARY <input type="checkbox"/> 1 DAYLIGHT 2 DAWN 3 DUSK 4 DARK - LIGHTED ROADWAY 5 DARK - NOT LIGHTED 6 DARK - UNKNOWN LIGHTING 7 GLARE 8 OTHER 9 UNKNOWN	<b>TYPE OF WORK ZONE</b> <input type="checkbox"/> 1 LANE CLOSURE 2 LANE SHIFT/CROSSOVER 3 WORK ON SHOULDER OR MEDIAN 4 INTERMITTENT/MOVING WORK 5 OTHER
	<b>LOCATION OF CRASH IN WORK ZONE</b> <input type="checkbox"/> 1 BEFORE FIRST WORK ZONE WARNING SIGN 2 ADVANCE WARNING AREA 3 TRANSITION AREA 4 ACTIVITY AREA
	<b>WORKERS PRESENT</b> <input type="checkbox"/> 1 NO 2 YES 3 UNKNOWN

<b>Truck/Bus</b> UNIT # <input type="checkbox"/> <input type="checkbox"/> THE CRASH INVOLVED ONE OR MORE OF THE FOLLOWING: A TRUCK (MOTOR VEHICLE) WITH GVWR MORE THAN 10,000 POUNDS; OR A TRUCK (MOTOR VEHICLE) WITH A HAZARDOUS MATERIALS PLACARD; OR A BUS DESIGNED FOR AT LEAST 8 PERSONS, INCLUDING DRIVER.	<b>A</b> THE CRASH RESULTED IN ONE OR MORE OF THE FOLLOWING: A FATALITY; OR <b>N</b> AN INJURY REQUIRING TRANSPORTATION FOR IMMEDIATE MEDICAL TREATMENT; OR <b>D</b> AT LEAST ONE VEHICLE WAS TOWED DUE TO DISABLING DAMAGE OR REQUIRED INTERVENING ASSISTANCE BEFORE PROCEEDING UNDER ITS OWN POWER
COMPANY (FROM SHIPPING PAPERS) ADDRESS (STREET, CITY, ST, ZIP CODE)	COMPANY PHONE

US DOT	ICC MC	PUCO	TRAILER LP ST.	TRAILER LP YEAR	TRAILER LP #	PLACARD #	# DEA
<b>CARGO BODY TYPE</b> <input type="checkbox"/> 01 NOT APPLICABLE <input type="checkbox"/> 02 BUS (9-15 INCLUDING DRIVER) <input type="checkbox"/> 03 VAN/ENCLOSED BOX <input type="checkbox"/> 04 GRAIN/CHIPS/GRAVEL <input type="checkbox"/> 05 POLE <input type="checkbox"/> 06 CARGO TANK <input type="checkbox"/> 07 FLATBED <input type="checkbox"/> 08 DUMP <input type="checkbox"/> 09 CONCRETE MIXER <input type="checkbox"/> 10 AUTO TRANSPORTER <input type="checkbox"/> 11 GARBAGE/REFUSE <input type="checkbox"/> 12 OTHER <input type="checkbox"/> 13 UNKNOWN	<b>Weight (GVWR)</b> <input type="checkbox"/> 1 LESS/EQUAL 10,000 <input type="checkbox"/> 2 10,001- 25,000 <input type="checkbox"/> 3 MORE THAN 25,000	<b>CDL Class</b> <input type="checkbox"/> 1 CLASS A <input type="checkbox"/> 2 CLASS B <input type="checkbox"/> 3 CLASS C <input type="checkbox"/> 4 CLASS M <input type="checkbox"/> 5 CLASS D	<b>Hazardous Materials Placard</b> <input type="checkbox"/> 1 NO <input type="checkbox"/> 2 YES <input type="checkbox"/> 3 UNKNOWN	<b>Hazardous Materials Released</b> <input type="checkbox"/> 1 NO <input type="checkbox"/> 2 YES <input type="checkbox"/> 3 NOT APPLICABLE <input type="checkbox"/> 4 UNKNOWN			

<b>Police Action</b>									
DATE CRASH REPORTED	TIME REC CALL	DISPATCH	ARRIVED	CLEARED	OTHER	TOTAL MINUTES			
0 1 2 4 2 0 1 0	1 5 3 9	1 5 4 0	1 5 4 8	1 6 2 0		4 0			
OFFICER'S NAME *	BADGE # *	CHECKED BY	DATE REPORT FILED*						
SERGEANT T. STANLEY	1 4	OFFICER J. LESLIE	0 1 2 5 2 0 1 0						
REPORT TAKEN BY	REPORT TAKEN AT	SUPPLEMENT * X IF YES	LOCAL REPORT # *						
1 1 POLICE AGENCY 2 MOTORIST	1 1 SCENE 2 STATION 3 OTHER		1 0 - 0 1 7						

OHIO TRAFFIC ACCIDENT - DIAGRAM/NARRATIVE CONTINUATION

OH-2 (Rev. 1/82)

LOCAL REPORT NUMBER 10-017	REPORTING AGENCY Butter Twp. Police Dept	DATE OF ACCIDENT M 01 D 24 Y 10
IN COUNTY OF MONTGOMERY Co.	ACCIDENT LOCATION 3318 W. NATIONAL Road	

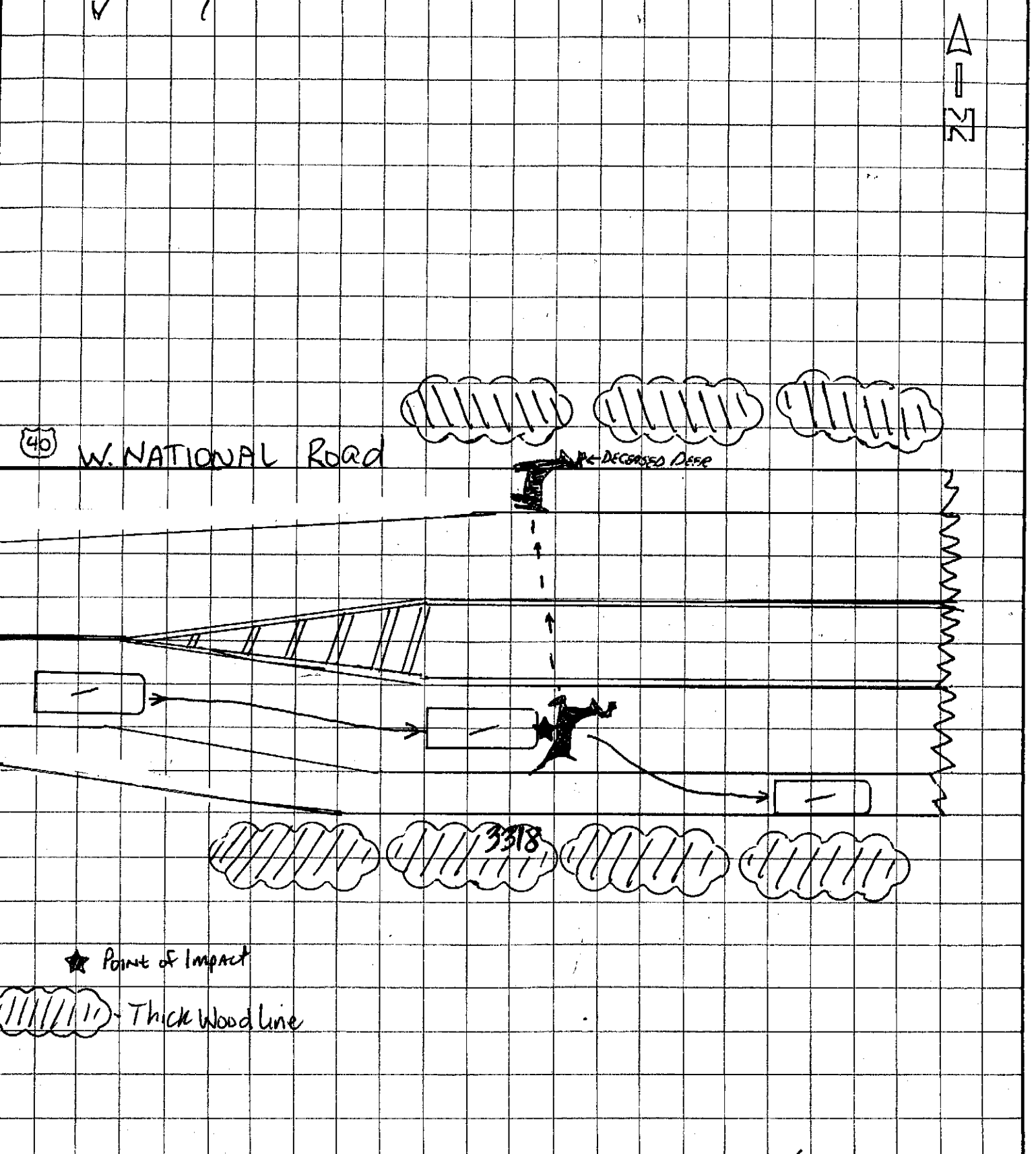

★ Point of Impact

Thick Woodline

NOT TO SCALE

OFFICERS SIGNATURE  
Det. J. [Signature]

BADGE NO.  
14